



Die Kompetenz
in Sachen Qualität

UNIVERSAL TRADING COMPANY



1973

يونيفرسال
UNIVERSAL

AEG

Electrolux

P.O. Box 4399, Abu Dhabi - United Arab Emirates

Tel: +9712 6335331 - Fax: +9712 6211957

<http://www.universal-uae.ae>

PRE-QUALIFICATION SUBMITTALS



Contents

Universal Trading Company - Profile	4
Projects Executed in Abu Dhabi & Dubai	11
Service Procedures	15
Certificate of Competance (Staff)	16
Nolte Kitchen - Company Profile	18
Nolte Kitchen - Product Profile	23
Nolte Product Test Report	36
AEG-Electrolux - Product Promise	39
AEG-Electrolux - Product Profile	40
AEG-Electrolux - Product Certification	55



يونيفرسال
UNIVERSAL

Universal Group, one of the most diversified and growing business enterprises in the UAE, was founded in 1973 by a vision of Mr. Shabeeb Al Dhaheri.

The group further made phenomenal progress after the entry of Mr. Hilal Al Dhaheri in 1977, who is presently the vice chairman of the group. Today, the Universal Group of Companies is a well reputed entity, which has carved a niche for itself by bringing in a number of world leading products into the UAE market to meet its volatile demands. Apart from the trading and agency activities, the group has established a name in various other activities like project contracting, engineering and sponsorship.

Universal Group, with its commitment to quality in its quest for constant excellence in all its ventures, has earned a remarkable position in the market. Universal Group with almost two and a half decades of strategic planning, inherent ability to identify opportunities added with its adaptability to changing market environment, has entrenched itself as a leader in the region's progressive market.

Group Companies:

Universal Trading Company

Universal Electrical Equipment Est.

Universal Rent A Car (EUROPCAR)

Universal General Transport Est.

Universal Real Estate

Universal Est. For Trading Agencies

Universal Service Centre

Universal Technical L.L.C.

Universal Voltas L.L.C.

Universal Weathermaker Factory L.L.C

Universal Auto Garage





يونيفرسال
UNIVERSAL

Universal Trading Company

Parent Company of the Universal Group

Established in 1973

Agencies of renowned companies

Major projects in Trading, Engineering and Sponsorship

Extensive distribution network

Excellent track record of progress and development

Exclusive agencies for internationally known companies and top manufacturers for world class machinery and domestic appliances including Industrial heavy equipment, Construction, Agricultural & Oilfield machinery, Generators, Material handling equipment, Refrigerators, Washing machines, Cookers, Kitchen cabinets and HVACR.

Service Back-Up & Parts Availability

The Importance of an effective and prompt after-sales service and maintenance can hardly be over emphasized. To provide the most satisfactory and prompt service, Universal Trading Company has a highly sophisticated and fully computerized, full-fledged services center in Mussafah, as well as various other centers with other branches of the company. These centers are managed by highly qualified and experienced engineers, specially for the plan machinery sold by us.

Besides this, Universal Trading Company also has a Spare Parts Department, with store facility in Abu Dhabi, Mussafah, Al Ain and Dubai. The department handles contractual supply to government departments and Oil Companies. It also looks after the speedy dispatch of information to the clients all their queries.

Domestic Appliances Service Center

Our Domestic appliances Services Center is situated in the heart of Abu Dhabi. This strategic location enables us to attend to customers' complaints promptly and provide them with easy access to the service center. Adequate stocks of spares and accessories are maintained for all the appliances that we sell in the UAE, while our service workshop is manned by qualified and highly experienced service technicians for all types of service facilities to the clients for the household appliances sold by us.

Spare parts and customer services are fully computerized which enable us to maintain a high degree of reliable and efficient after sales service. Similar Service Centers are attached to all our branches in the UAE. The Spare Parts Department in Abu Dhabi is situated at Mussafah. It has a large store which stocks a sufficiently large quality of spare parts, for all the items sold by us. This department has a long record of contractual supply with government departments and oil companies and continues to be one of the major suppliers in the country.

The department is staffed with highly energetic personnel. Our business relations have been cemented by clubbing up the clients' goodwill and our enthusiasm is serving them. With a proven track record of good client, relations, we are hopeful of a more promising tomorrow.

We have similar stores in Al Ain and Dubai, under our branch offices in those parts. These stores are also capable of meeting any big project requirement.

It goes without saying that all spare parts supplied by us are tested and approved by a thorough and computerized quality control process.



يونيفرسال
UNIVERSAL

Universal Electrical Equipment Est.

Universal Electrical Equipment Est., is one of the reputed and most diversified and fast growing business firm in the UAE. Founded in 1973, UEEE scope of activities encompasses Trading, Engineering and Sponsorship. We are the sole agents and distributors for various world-renowned Household Appliances, i.e. AEG, IGNIS, NARDI, TURBO, X-PER, NORGE, Universal...etc. All these products are backed by a prompt and an efficient after sales service team of experts and technicians.

Universal Rent A Car (EUROPCAR)

Universal Rent a Car (URC) was established in 1980 and represents Europcar in Abu Dhabi owned by Mr. Shahbeeb Al Dhaheri , which is ranked as one of the leading company in Abu Dhabi and Al Ain.

Universal Rent a Car (Europcar) operates a large fleet with varieties of vehicles from major automobile manufactures. Fleet of vehicles can be categorized like small saloon cars (Toyota Echo, Mazda 323, Nissan Sunny, VW Polo, Chevrolet Aveo, VW polo Classic, Toyota Corolla, Honda Civic etc..), medium cars (Toyota Camry, Mazda 6, VW Golf, Nissan Maxima, VW Passat, Opel Omega, Honda Accord etc.) American cars (Chevrolet Lumina, Chevrolet Caprice etc), Luxury cars (Mercedes, Peugeot 607, Lexus, BMW etc), and 4WD Vehicles (Toyota Land Cruiser, Nissan Patrol, Nissan Pathfinder etc).

Company's main business is renting and leasing vehicles. Contract for lease period varies from 1 to 4 years. For commitments of lease above 9 months the company would provide brand new cars. Apart from this, Universal Rent A Car's (Europcar) businesses are chauffeur drive, drop off and pick up, renting mobile phones etc. There are special rates for the corporate companies and as well as there is special weekend and summer rates for short-term rental.



يونيفرسال
UNIVERSAL

Universal Real Estate

Since its inception as a group member of Universal Group of Companies, Universal Real Estate has gained the skills in real estate services and gradually mastered them to suit your taste and preference. We believe that the role of real estate consultant is the key to the successful outcome of any deal/project. As a professionally managed property agents in UAE. We have rich experience and knowledge of the local real estate market. Our team of professionals pays personal attention to bring extraordinary results in property deals / investments.

At Universal Real Estate, we continually challenge ourselves to look for new and better ways to add value, enhance efficiency and increase profits for our clients. We at Universal Real Estate provide comprehensive property solutions. Our main aim is to provide quality real estate services to customers, We specialize in providing liaison and consultancy services for residential houses, commercial buildings, industrial plots / premises, investments, development projects / townships in UAE.

Universal General Transport Est.

Another milestone in Universal Group's diversification is Universal General Transport Est., a 100% local company established in 1991. The company offers material transportation services backed by a well-maintained fleet of vehicles and the workforce of highly skilled and talented professionals.

As part of Universal Group of Companies, Universal General Transport Est. always adopts the group's policy of maintaining highly reliable customer service and uncompromising commitment to customer satisfaction to enjoy the pleasure of genuine success in today's competitive market. Since its inception, Universal General Transport Est. is continually evolving its business to meet the volatile demands and specific needs of changing market environment of the region.

Enabling elegant lifestyles

Universal - the name is synonymous with premium home appliances since 1973. A presence in every discerning home that evokes trust and quality with the finest European brands in the market.

Universal is sought by customers who seek excellence and value for money because of its unfailing focus on customer service and satisfaction. Prompt and reliable after sales support is ensured with a highly sophisticated and fully computerized service center in Mussafah in Abu Dhabi. Through its exclusive outlets in strategic locations in Abu Dhabi, Dubai and Al Ain, Universal Trading is the sole marketer for such leading European brands as AEG, XPER, Ignis, Nardi, Nolte Küchen and Torchetti.

Universal Trading. A member of the Universal Group. A group with highly diversified interests ranging from electrical equipment to transportation and real estate to heavy industrial goods. With a flawless reputation for being the best. And first with the finest.

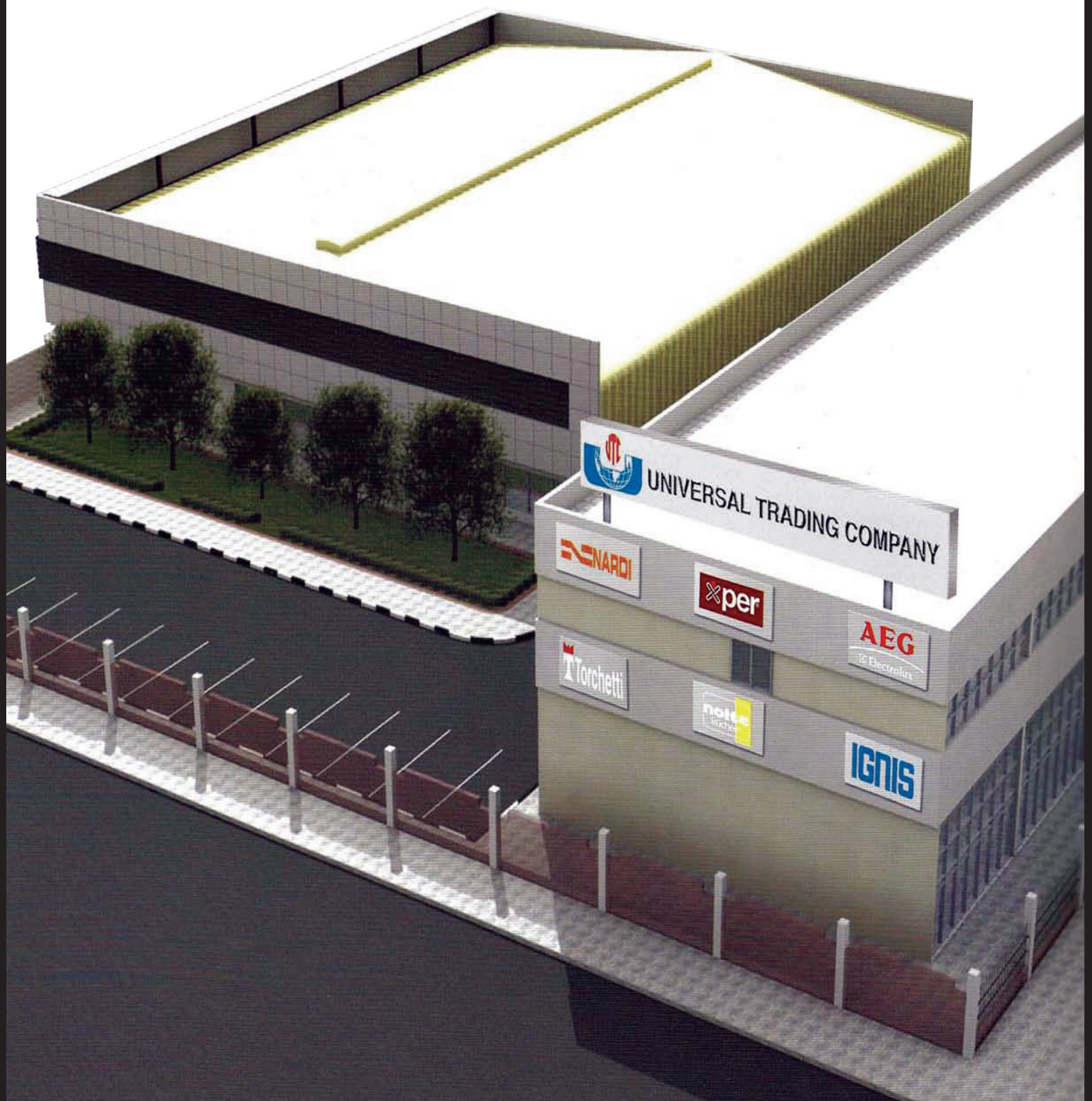



Comprehensive Kitchen Solutions from Universal Trading Company

Universal Trading Company are exclusive representatives in the United Arab Emirates for Nolte Kitchens and AEG Kitchen Appliances since 1973 offering comprehensive kitchen solutions for commercial and residential projects in the UAE.

Nolte Kitchens are Germany's second largest brand and specialise in individually planned high grade kitchens that suit individual style, requirements, space and budget. It is this ability to customize that has made Nolte the ideal personal partner in home building for a number of our customers.

AEG is the icon of the contemporary Home Appliances in Germany. The leading edge in style and technology are reflective of the company's innovative culture and its continuous endeavours to set the industry standards at new heights.

Together with Nolte Kitchens and AEG-Electrolux we combine our strengths and expertise to bring you a total satisfying experience.





يونيفرسال
UNIVERSAL

Our Product Offering

Kitchens



*Die Kompetenz
in Sachen Qualität*



Domestic Appliances



Universal Trading Company

List of Major on going and executed projects

No.	Project Name	Number of Apartments	Main Contractor/Client	Consultant	Location	Product
1	Burj Khalifa (Burj Dubai) - Lake Hotel - Emaar Properties	626 Apartments	Cairncross Martin LLC Emar Business Park	FF & E consultant	Dubai	Kitchen Equipment
2	Burj Khalifa - Armani Hotel - Emaar Properties	150 Apartments	Fino International		Dubai	Kitchen Equipment
3	Al Bustan Complex (Mixed Use Development)	478 Apartments - 3 Towers	Al Habtoor Eng'g. LLC	The Cox Group	Abu Dhabi	Kitchen Equipment
4	Sama Tower - Al Durrah Tower - Shk. Zayed Road Dubai	376 Apartments	Dubai Contg. Co. LLC	WS Atkins/ Hill International	Dubai	Kitchen Equipment
5	The Palm Jumeirah - Oceana Project	630 Apartments	Seven Tides Property - ASTECO Property Management	Dar Al Handasah	Dubai	Kitchen Equipment
6	Al Bahar Palace - HH Shk. Hamdan Bin Zayed Al Nahyab	3 Luxury Villas	Commodore Contracting Co. LLC	Dar Al Khaleej	Abu Dhabi	Nolte Kitchens
7	Green Lakes - Jumeirah Lake project, Cluster 51,52 & 53	722 Apartments	Al Basti & Muktha L.L.C		Dubai	Kitchen Equipment
8	Ontario Tower - Mr. Khalid Al Mutawwa	285 Apartments	AB Building Contg. LLC		Dubai	Nolte Kitchen cabinets and appliances
9	Liwa Heights - Jumeirah Lake Towers P 303	169 Kitchens & 136 Pantries	Dhafir Development & Contg. LLC	KEO Int'l	Dubai	Kitchen Cabinets

Universal Trading Company

List of Major on going and executed projects

10	Emirates Al Marsa Tower Emirates Airlines Dubai	420 Apartments	Italia Kitchen & Laundry Equip. LLC Dubai		Dubai	Kitchen Equipment
11	Al Hamed Group - 2 Comm. Bldgs. C132&133	180 Apartments	Code Contracting Company LLC	Al Suwaidi Consultant	Abu Dhabi	Kitchen Equipment
12	Shangri La Hotel (BTB Project) Hotel Apartments. Umm Naar - Abu Dhabi	161 Hotel apartments	Al Jaber Energy Services Post Box: 46467, Abu Dhabi		Abu Dhabi	Kitchen Equipment
13	Bonnington Tower - Jumeirah Lake Towers	260 Apartments	Bonnington Group LLC (Dubai Contg. Co.)		Dubai	AEG Kitchen Equipment
14	Mr. Abdulla Al Fahad	2 Luxury Kitchens	Al Fahad Contg. Co		Dubai	Nolte Kitchens & AEG Appliances
15	Al Raha Towers - Abraj Development. - Al Dar Properties	200 Apartments	Al Fara'a General Contg. Co.	A.P.G	Abu Dhabi	Wardrobes
16	Dr. Hassan Rashid Ahmed Al Abbar Building - Dubai Investment Park	80 Kitchens & 80 Pantries	Al Abbar Gen. Contg.	Delta Eng'g.	Dubai	Kitchen cabinets and appliances
17	Shk. Mubarak Bin Mohd Al Nahyan - Comm. Buildings		Dhafir Development & Contg. LLC	Dewan	Abu Dhabi	Kitchen cabinets

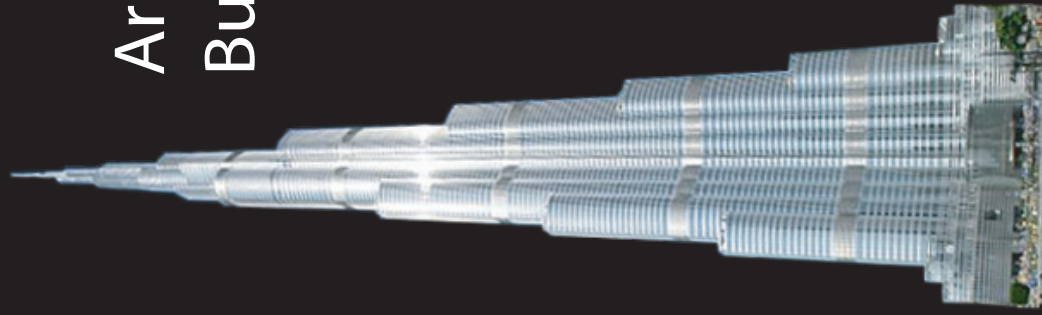

Armani Residences Dubai Burj Khalifa

The
**Thoughtful
Performance**
Provider

A home with the best performing appliances, where people feel completely in control.



Universal Electrical Equipment Est.
Dubai - UAE.
Tel: 04 3248112 - Fax: 04 3248113

AEG
PERFEKT IN FORM UND FUNKTION 

AEG Kitchen Appliances

The Armani Residences complements the Armani Hotel and provides a complete lifestyle experience. The one- and two-bedroom luxurious residences are furnished with AEG-ELECTROLUX Built-in Kitchen Appliances.





COMFORT INN HOTEL

LUXURY APARTMENTS & PENTHOUSES TECOM - Dubai



Equipped with AEG Electrolux & NARDI
Built-In Kitchen Appliances

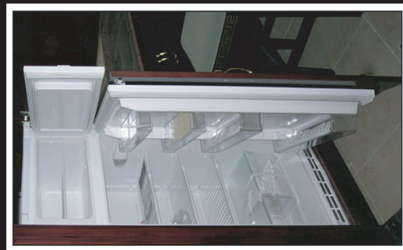

AEG-Electrolux built-in range has been created with premium kitchens in mind - with design that enhances the overall look of the kitchen, together with the latest high-performance technology to meet the most uncompromising standards.

Over 50 years Nardi has experienced the changes that have given life to new trends in design and technology and have always been capable of anticipating them offering intelligent products that make of aesthetics and functionality their ground values.

Supplied, installed and commissioned by:



Universal Electrical Equipment Est.
Dubai - UAE. Tel: 04 3248112

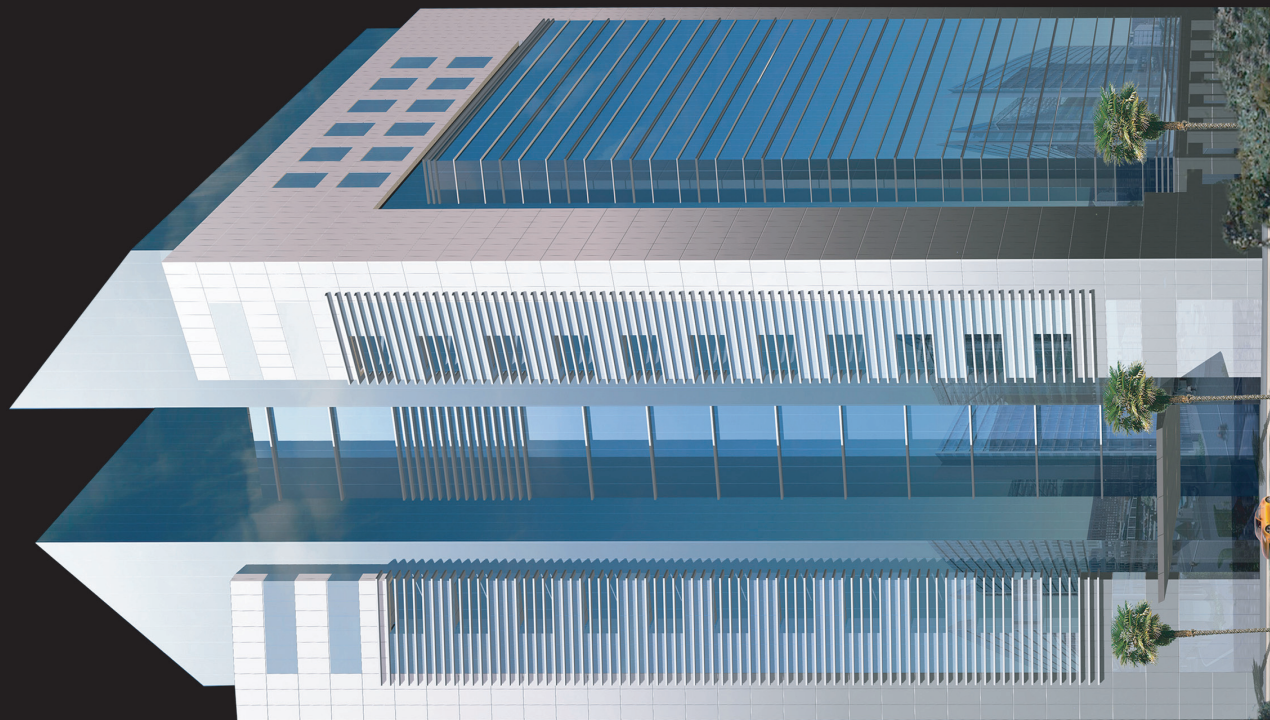

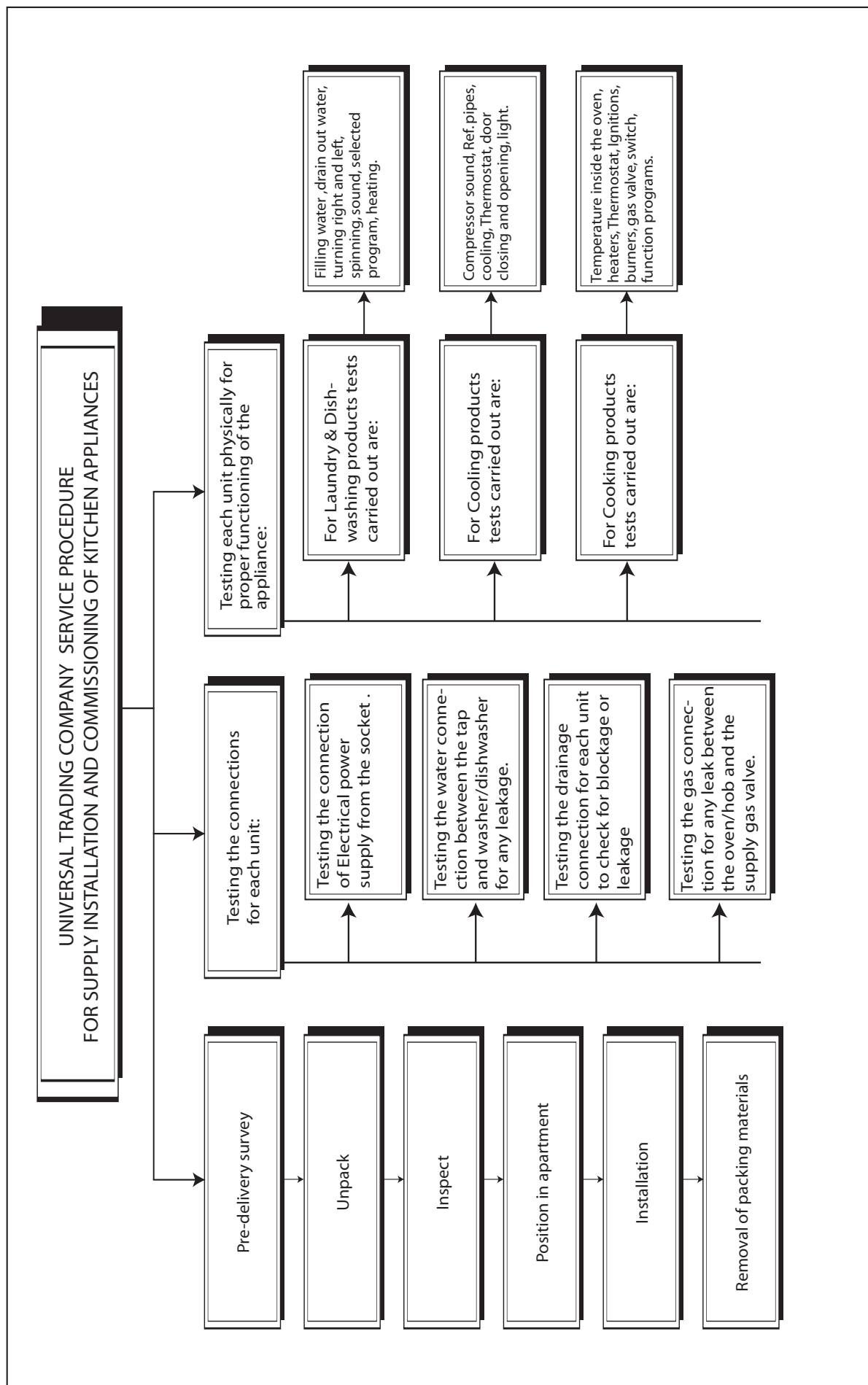

Certificate of Competance

for

Manohar Chandran

Nolte Export Technical Training 2010 in Product & Design

- Matrix 150
- Winner Computer Design Skills
- 2011 Product Innovations
- 2011 Showroom Analysis
- Design & Planning Techniques

October 2010



Export Operations Manager

i.A. Richard Pedgrift

Certificate of Competance

for

Hussam Ahmed Al Yazji

Nolte Export Technical Training 2010 in Product & Design

- Matrix 150
- Winner Computer Design Skills
- 2011 Product Innovations
- 2011 Showroom Analysis
- Design & Planning Techniques

October 2010



Export Operations Manager

i.A. Richard Pedgrift



*Die Kompetenz
in Sachen Qualität*

Nolte Kitchen



Die Kompetenz
in Sachen Qualität





Une exigence sans faille depuis plusieurs générations.

Nous sommes fiers de ce que la société nolte enregistre des succès depuis quatre générations déjà. Ceci est possible car nous avons toujours géré notre entreprise dans le respect des valeurs traditionnelles, tout en privilégiant le long terme dans nos choix d'investissements. Cela nous permet d'apporter une réponse économique à l'avenir de notre entreprise face aux défis de la globalisation.

Wir sind stolz darauf, dass bereits die vierte Generation bei nolte erfolgreich im Unternehmen tätig ist. Dieses ist möglich, da wir unser Unternehmen stets auf der Basis von echten deutschen Tugenden geführt und weitsichtig antizyklisch investiert haben. Somit haben wir auch eine wirtschaftliche Antwort auf die Zukunft unseres Unternehmens in der globalisierten Welt.

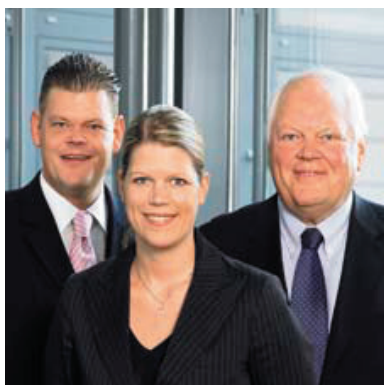

Dedicated to achieving the highest standards for generations.

We are proud that this is already the fourth successful generation working at nolte – made possible by farsighted, counter-cyclical investments and our uninterrupted philosophy of managing the company on the basis of true German virtues. As a result, we also have a viable business response for our company's future in a globalized economy.

Respondiendo desde hace generaciones a las demandas más exigentes.

Es para nosotros un orgullo que hoy en día nolte se encuentre en las exitosas manos de la cuarta generación. La puesta en práctica de las tradicionales virtudes alemanas en la gestión así como una previsora política de inversión anticíclica lo han hecho posible. De este modo hemos desarrollado una respuesta económica para el futuro de nuestra empresa en el mundo globalizado.



nolte küchen
nolte Germersheim
Express
CS Schmal
Drum Systeme
nolte Holzwerkstoff
Reber Möbel-Logistik
nolte Produktenwerk
nolte Stiftung

Qualität made by nolte, made in Germany – in der ganzen Welt zu Hause.

Da wir frühzeitig erkannt haben, dass man aus Deutschland nur Möbel mit gehobenem Design und höchster Qualität liefern kann, haben wir uns auf diese Merkmale konsequent eingestellt und sind damit von Jahr zu Jahr erfolgreicher in der ganzen Welt. Wir setzen als Innovationsführer immer wieder neue Impulse im Markt und fertigen unsere Produkte umweltgerecht und nach den neuesten Technologien.

Quality made by nolte, made in Germany – at home anywhere in the world.

We recognized very early on that it is possible to supply furniture for sophisticated tastes and of unparalleled quality from Germany. Consequently, we consistently focused on these attributes and became more and more successful the world over from year-to-year. As an innovation leader, we repeatedly serve as a new source of inspiration for the market. We manufacture our products using environmentally sound processes and the latest technologies.

La qualité signée nolte, made in Germany – Une qualité qui s'impose dans le monde entier.

Nous avons reconnu très tôt que pour fabriquer des meubles en Allemagne il n'y avait pas d'autre choix que d'offrir une qualité irréprochable. Nous avons logiquement fait nôtre cette exigence, ce qui nous a permis d'améliorer nos résultats dans le monde entier, année après année. Notre avance en matière d'innovations nous permet de donner sans cesse un nouvel élan au marché et de fabriquer nos produits dans le respect de l'environnement et avec les technologies les plus modernes.

Calidad nolte, made in Germany:

presente en todo el mundo. El haber percibido desde el principio que desde Alemania no se puede sino crear muebles de alto diseño y máxima calidad nos ha permitido centrarnos en estos signos distintivos y cosechar de este modo éxitos cada vez mayores. En todo el mundo. Año tras año. En calidad de líderes de innovación, marcamos continuamente nuevos impulsos en el mercado y fabricamos nuestros productos con el máximo respeto al medio ambiente y haciendo uso de las tecnologías más avanzadas.



Germersheim



Rheinspan : Plus de 1 500 m³ panneaux en fibre de bois par jour –

La technique de pointe à l'œuvre.

Une qualité incomparable, pour des produits fabriqués selon un cycle de production complet et innovant, dans le respect des ressources et de l'environnement (conformité EMAS II). Les produits sont fabriqués 24 heures sur 24 dans l'une des usines de panneaux en fibre de bois les plus modernes. Réalisés en 7,50 x 2,62 m, les panneaux sont ensuite découpés aux mesures fixes souhaitées par les clients. L'usinage des produits se poursuit, à partir des rouleaux de papiers mélaminés, dans la plus grande presse de revêtement en Europe. Le groupe nolte a accumulé plus de 50 ans d'expérience dans la fabrication des panneaux en fibre de bois. Ceci en fait la plus ancienne entreprise familiale de fabrication de panneaux en fibre de bois qui soit.

Rheinspan: Über 1.500 m³ Spanplatten pro Tag – modernste Technik am Werk.

In bester Qualität, hergestellt in einem zukunftsweisenden, geschlossenen Produktionskreislauf – ressourcenschonend und umweltgerecht (nach EMAS II). Rund um die Uhr werden in einer der modernsten Spanplattenanlagen Produkte in dem Maximalmaß 7,50 x 2,62 m hergestellt, die im Anschluss auf die gewünschten Kundenfixmaße zugeschnitten werden. Zur weiteren Veredelung arbeitet die größte Beschichtungspresse Europas direkt von der Melaminpapierrolle. Die nolte Gruppe kann auf über 50 Jahre Erfahrung im Herstellen von Spanplatten zurückblicken. Und ist somit der älteste Spanplattenhersteller der Welt in Familienbesitz.



Rheinspan: Over 15,000 m³ of chipboard per day – advanced technology in operation.

Top quality, manufactured using a trendsetting, closed production cycle – minimal resource consumption and environmentally sound (to EMAS II). Around-the-clock, the state-of-the-art chipboard manufacturing systems produce products with a maximum size of 7.50 x 2.62 m, which are subsequently cut to the specified customer dimensions. The largest coating press in Europe, directly fed by a melamine paper roll, is used for further finishing. The nolte Group can look back on over fifty years of experience in chipboard manufacturing, making it the oldest privately owned chipboard manufacturer in the world.

Rheinspan: más de 1.500 m³ de aglomerado por día: la tecnología más avanzada.

Con la mejor calidad, fabricados en un ciclo de producción cerrado y de filosofía innovadora, respetando los recursos naturales y el medio ambiente (conforme a las disposiciones de EMAS II). Las veinticuatro horas del día y en una de las plantas de aglomerado más modernas se producen tableros de dimensiones máximas de 7,50 x 2,62 que inmediatamente después se recortan al tamaño solicitado por el cliente. Para obtener un acabado extra del producto se emplea la prensa de revestimiento más grande de Europa, que trabaja directamente con rollos de melamina. El grupo nolte se sustenta sobre 50 años de experiencia en la producción de tableros de aglomerado. Como propiedad familiar, es el fabricante más veterano del mundo.

Fronts



MatrixLine 150 Front overview

MATRIXLine150®
by notte küchen

PG 1					PG 2				PG 2			
	COLOR LINE 11W white	COLOR LINE 11P purple	COLOR LINE 11Q metallic quartz grey	COLOR LINE 11O metallic ocean		SATIN GLASART 28W white soft mat	SATIN GLASART 28M magnolia soft mat	SATIN GLASART 28T terra soft mat		STYLE 121 gloss mother-of-pearl metallic	STYLE 125 gloss sapphire yellow metallic	
PG 1									PG 2			
	MANHATTAN 491 off-white / magnolia	MANHATTAN 493 metallic kubant	MANHATTAN 49N italian walnut	MANHATTAN 49S savannah acacia	MANHATTAN 492 rose anador	MANHATTAN 49C boston cherry	MANHATTAN 49W african vergé			NOVA BASIC 13P oak polar silver	NOVA BASIC 13R oak smoky silver	
PG 3												
	STAR 27W white	STAR 271 off-white / magnolia	STAR 276 vanilla	STAR 272 sand beige	STAR 27K copper	STAR 27S aluminum look	STAR 27G basalt grey	STAR 27A silver maple "nature"	STAR 27N italian walnut	STAR 27C cubana "nature"		
PG 3				PG 3					PG 4			
	UNI PLUS 141 natural white	UNI PLUS 14M magnolia	UNI PLUS 14S savannah acacia		NOVA BRILLANT 29W high-gloss white	NOVA BRILLANT 29M high-gloss magnolia	NOVA BRILLANT 29G high-gloss quartz grey			SOFT LACK 76W white soft mat	SOFT LACK 76M magnolia soft mat	SOFT LACK 76P purple soft mat
PG 4									PG 4			
	CHICAGO 540 high-gloss magnolia	CHICAGO 543 high-gloss metallic kubant	CHICAGO 545 high-gloss lemon green	CHICAGO 541 high-gloss metallic quartz grey	CHICAGO 542 high-gloss metallic ocean	CHICAGO 544 high-gloss purple				TREND LINE 531 magnolia	TREND LINE 533 bronze	TREND LINE 532 african vergé
PG 5									PG 6			
	SPOT 180 high-gloss white	SPOT 18M high-gloss magnolia	SPOT 18S high-gloss vanilla	SPOT 18T high-gloss terra	SPOT 18G high-gloss solar yellow	SPOT 18R high-gloss ruby red	SPOT 18B high-gloss night black	SPOT 18E high-gloss ebony		TREND LINE PLUS 53M high-gloss magnolia	TREND LINE PLUS 53T high-gloss terra	
PG 6				PG 7								
	NOVA PEARL 73W white	NOVA PEARL 73M magnolia			NOVA LACK 731 high-gloss white	NOVA LACK 732 high-gloss magnolia	NOVA LACK 736 high-gloss vanilla	NOVA LACK 733 high-gloss plain kubant	NOVA LACK 735 high-gloss terra	NOVA LACK 734 high-gloss purple	NOVA LACK 737 high-gloss light grey	

Carcase



Carcase

- Three-layer chipboard, 16 mm thick, DIN EN 312
- Melamine resin on both sides
- Rear panel HDF, thickness 3.2 mm
- Multiple glued dowel pins
- 64 mm drilling grid for adjustable shelves

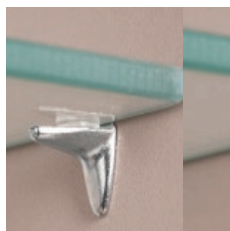

Interior Decor

- The carcase interior colour corresponds to the carcase exterior colour as standard for all models
- Delivery at no additional cost



Adjustable shelves / glass shelves

- Adjustable wood shelves with PP thick edge at the front
- Glass shelves in safety glass
- All-metal shelf supports
- Shelf supports for wooden shelves with pins for secure fixing of the adjustable shelf
- Shelf supports for glass shelves with rubber coating
- Glass shelves have a load-bearing capacity of 10 kg

Sealed edge

- Carcase front edge with matching PP sealed edge
- Matching profiled seal
- Reduces the dust accumulated inside the cabinet
- Doors and drawers close quietly

Worktops



Worktops, thickness 40mm

- 51 finishes in 3 decor groups: Classic, Premium, Brilliant
- maximum length: 5100 mm, maximum depth: 1200 mm
- matching edge finishing and additional special edges
- high quality 3-layer structure, coated with laminate
- Underside coated with water-repellant, resin-impregnated paper
- Illustration shows edging finish EVS - metal look/black



Worktops, thickness 50mm

- 37 finishes in 3 decor groups: Classic, Premium, Brilliant
- maximum length: 5100 mm, maximum depth: 1200 mm
- 50 mm panels available in matching decors and colours
- matching edge finishing and additional special edges
- high quality 3-layer structure, coated with laminate
- Underside coated with water-repellant, resin-impregnated paper

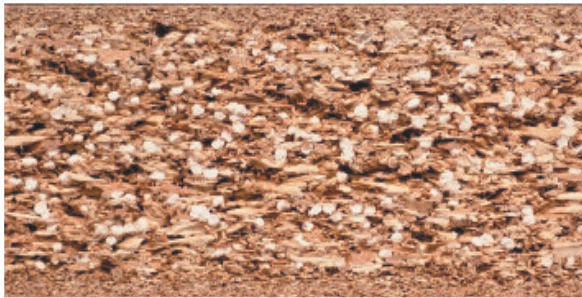

"AirMaxx" lightweight worktop, 50mm thick

- a saving in weight of almost 35 % in comparison to a standard worktop and 20 % in comparison to a conventional lightweight worktop
- the extremely sturdy centre ply allows perfect corner joins



Patented worktop connection

- Join by a groove and plastic moulded components
- Additional fixing by metal tensioning screws
- Resulting in a secure hold and an even surface
- Easy to install
- European patent for Nolte Küchen

Sealing of the underside of the worktop

- APD finishes receive sealing of all surrounding edges of the underside with a coating which is impermeable to water.
- This substantially prevents swelling of the worktop in the area of dishwashers for example

Worktops / recess panelling



Worktops, thickness 16mm

- 16 finishes
- maximum length: 5100 mm, maximum depth: 1200 mm
- matching edge finishing and additional special edges
- both sides coated with laminate



Recess panelling NVD

- Thickness 16 mm
- All-around, matching thick edge
- Available in all worktop finishes in addition to stainless steel look and aluminium look
- maximum size: 3500 x 1200 mm
- Profiled seal



Recess panelling in glass

- 16 mm thick, including 4 mm glass coating lacquered on the rear
- 5 colour versions: white, magnolia, grey, purple and black
- Concealed suspension, incl. rear fixing and wall hooks
- Drill holes / cutouts for sockets, wall clip-on shelves, extractor hoods etc. are produced at the factory.
- maximum size: 2400 x 1250 mm, minimum dimensions: 100 x 250 mm
- Profiled seal



Glass recesses with emotional motifs

- Choice of 6 motifs in the widths 600, 800, 900, 1000, 1200, 1600 and 1800 mm
- Motif is designed for the maximum recess width and height, and will be shortened to the ordered size at the top and on the right.
- Angles, drill holes and milling not available.



Drawer system



Interior drawers

- Load-bearing capacity up to max. 40 kg
- Suitable interior organisation
- Illustration shows finish with ChromLine - subject to extra charge



Interior pull-outs

- Load-bearing capacity max. 40 kg up to a width of 600 mm
- Load-bearing capacity max. 80 kg from a width of 800 mm upwards (from a pull-out depth of 600 mm upwards)
- Suitable interior organisation
- Illustration shows finish with ChromLine - subject to extra charge

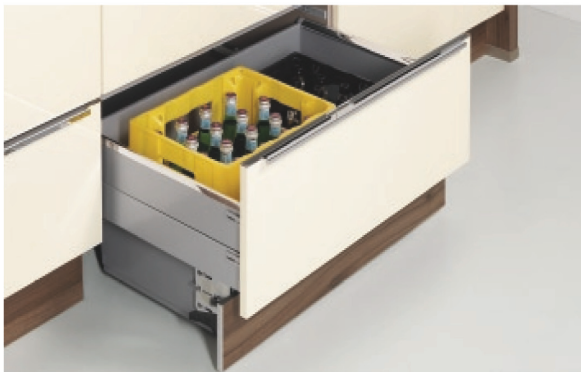

Base units with large-capacity pull-outs

- Can be used from 150 mm plinth height
- Available in widths of 600, 800 and 900 mm
- Load-bearing capacity max. 40 kg up to a width of 600 mm
- Load-bearing capacity max. 80 kg from a width of 800 mm upwards (from a pull-out depth of 600 mm upwards)
- Illustration shows finish with ChromLine - subject to extra charge



Plinth drawers

- Can be used from 120 mm plinth height
- Available from a unit width of 450 mm and above

Waste separation



Waste separation system

- Available widths 600, 800, 900 and 1000 mm
- Model code SUZ...
- Pull-out with waste separation system behind
- Integrated top cover to neatly cover the waste bins



Waste separation system with large-capacity pull-out

- Available widths 600, 800 and 900 mm
- Model code SABS...
- 1 pull-out with metal rail for dishwashing utensils
- 1 large-capacity pull-out for waste separation system
- Integrated top cover to neatly cover the waste bins
- Available from 150 mm plinth height
- Waste separation system (MES) must be ordered separately



Waste separation system

- Available widths 450, 500 and 600 mm
- Model code SABD...
- 1 pull-out with waste separation system
- Integrated top cover to neatly cover the waste bins
- The number of waste bins varies according to the unit width

Hobs / corner solutions



reddot design award
winner 2005

Cooker units

- Aperture height 600 mm
- Handleless drawer under the cooker (Ill. on left UHSK 60)
- From 120 mm plinth height, available with large-capacity pull-out (Ill. on right UHS 60).
- UHS-Large-capacity pull-out with 2 levels - top level suitable for baking trays



Hobs

- Standalone hobs
- Unrestricted use of the drawer under the hob (except for induction hobs)
- Include touch guard (BSCHUTZ) in the order



Corner solutions in the base unit area

- **Corner units with carousel**
(Ill. on left UEK 80, 90)
Carousel rotatable through 360°
- **Corner units with pivoting tray shelves**
(Ill. on right UELAD)
- For both versions, each shelf has a load-bearing capacity of max. 20 kg
- Illustration shows version with ChromLine - subject to additional charge



Larder units in the base unit area

- **Pull-out unit with storage baskets** (Ill. on left UVK 30)
3 adjustable baskets, load-bearing capacity of pull-out 30 kg
- **Stile units** (Ill. on right UK.. 15)
available in front finish and stainless steel or aluminium look, ribbed
available with storage baskets and / or towel rails
- Illustrations show version with ChromLine - subject to additional charge

Tall units



Pharmacy units

- Available in 300 and 400 mm width
- Available in all tall unit heights
- Partial extension, at an additional charge also with full extension and cushioning
- Pull-out with a load-bearing capacity of max. 100 kg
- Illustration shows version with ChromLine - subject to additional charge -



"LeMans" corner unit

- 4 carousel shelves, can be pivoted out completely
- Each carousel shelf has a load-bearing capacity of max. 20 kg
- Available in carcase height 1350 and 1500 mm
- Illustration shows version with ChromLine - subject to additional charge -



Larder unit

- Available in 450, 600 and 900 mm width
- Available carcase heights: 1950, 2100 and 2250 mm
- Pull-out and door shelf with a load-bearing capacity of 50 kg
- Illustration shows two 450 mm wide units and version with ChromLine - subject to additional charge -



Tall units with sliding doors

- Larder units
- Broom cupboards
- Not available in all ranges and carcase heights
- supplied as knock-down unit



Tall units with glass

- Available in all tall unit heights
- 6 available glass finishes
- Illustration shows glass finish WLG - white glass lacquered

Technical details



Hinge without cushioning

- All-metal finish, adjustable in three dimensions
- Toolless rapid installation / removal of the doors
- Opening angle 105°

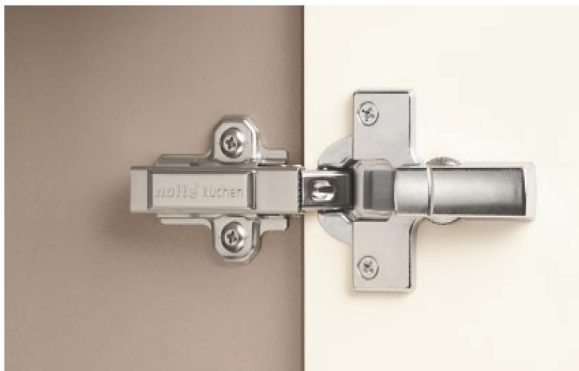

Hinge with cushioning

- Push-fit cushioning element
- All-metal finish, adjustable in three dimensions
- Toolless rapid installation / removal of the doors
- Opening angle 105°



Hinge with cushioning for glass door

- Separately installed cushioning element
- All-metal finish, adjustable in three dimensions
- Toolless rapid installation / removal of the doors
- Opening angle 105°



Novomat wall unit fitting

- All-metal finish, adjustable in three dimensions
- Cover cap for a neat appearance inside the unit
- Special adjusting tool **NOVO FIX**
- Fitting firmly secured to the carcass by means of harpoon plugs and screw connection
- Metal suspension strip / screws
- Load-bearing capacity up to 65 kg

Technical details



Pivoting / folding flap fittings

- With cushioning as standard
- Illustration on left for pivoting flap door units HL...
- Illustration on right for folding flap door units HFK...



Plinths

- Per unit, at least four adapters firmly connected to the carcass to receive the plinth feet
- Standard plinth heights of 90, 120 and 150 mm
- Plinth heights of 90 to 300 mm possible at an additional charge
- From plinth height 120 mm, plinth drawers can be planned; from plinth height 150 mm, large-capacity pull-out drawers can be planned.



Plinth panel / installation tool

- Chipboard according to DIN EN 312, 12 mm thick
- Direct coating on a melamine resin base, optionally veneered or lacquered
- Join with floor by 5 mm thick PP sealing profile, waterproof
- The plinth panel is firmly pressed on to the floor by means of catch elements
- Easily fitted and removed for cleaning.
- 3-part installation tool **MULTI FIX** available as an accessory

Quality is a secure value

Quality knows no compromises. Stringent tests form the basis for why our kitchens still continue to function safely and reliably even after many years of use. The GS symbol for all our kitchens and the grade awarded by the German Stiftung Warentest are evidence of their high quality standard.

Our quality

1. Carcase

- The **carcase front edge** is coated with a **sealed edge in the same decor**, comprising a **PP thick edge with integrated, matching profiled seal**. This reduces the **dust accumulated inside the cabinet** and additionally ensures that **doors and drawers close quietly**, thus **adding value** to the furniture in general.
- Visible carcase sides, panels, pilasters, plinth panels, cornices and light pelmets** can be supplied on request in selected decors and colours, **gloss, lacquered or veneered**.
- Multiple doweling** results in high **stability and load bearing capacity** of the individual carcase elements.
- The **interior of the units** matches the **outside of the carcase** as standard.
- The **front edge** of the fixed and height adjustable **carcase shelves** is equipped with a **PP thick edge**. The drilling grid for the adjustable shelves is 64 mm. This results in **excellent space utilisation** and even more **storage space**.
- Our units are available in 300, 400, 450, 500, 600, 800, 900, 1000 and 1200 mm widths. Spacefiller units are available in 350 mm widths.
- The **carcase depth** for **base units** is **560 mm** (some models also available in depths 350, 460 and 710 mm), for **wall units 350 mm** and for **tall units and appliance housings 560 mm** (some models also available in depth 350 mm).
- Base units** are available in heights 750, 600 and 300 mm, **wall units** in heights 300, 450, 600, 750 and 900 mm. **Tall units and appliance housings** are available in heights 1350, 1500, 1950, 2100 and 2250 mm.
- The back walls of base and tall units are recessed by 42 mm. **No expensive hidden wiring** behind base units is therefore required. Pipes and cables can be surface-mounted, an important cost-saving factor when replanning existing kitchens or in old houses and apartments.

2. Technology

- The **technical equipment** and the **unit ranges are not different** in terms of variety and quality in the individual price ranges.
- Maintenance-free** drawer and pull-out runners in sturdy steel frames ensure **long reliable service** and are equipped in addition with a low-noise self-closing mechanism.
- All drawers and pull-outs are **fully extensible** as a **standard feature**. High side frames and high rear panels guarantee **maximum use of the storage space available**. **Complete interior organisation** is available for the drawers and pull-outs. On request, drawers, pull-outs and doors can be equipped at an additional charge with a **cushioning system**.
- Drawers and pull-outs can be removed without tools. This facilitates care and cleaning.
The maximum load equals
for drawers max. 40 kg,
for pull-outs up to 600 mm max. 40 kg,
for pull-outs up to 1000 mm max. 80 kg,
and for pull-outs, 500 mm deep max. 40 kg.
- Wall units are secured using a metal rail and a special fitting which is easily adjustable in 3 directions. Provided that doweling is performed in accordance with DIN, load bearing capacity is 65 kg.
- Doors are equipped with self-closing all-metal clip hinges and by means of the latter, can be removed from the hinges and replaced without the use of tools. The hinges are adjustable in 3 directions and depth adjustment is performed via a concealed cam fitting. All-metal finish ensures **no material fatigue or wear**.
- Plinths are fitted **without screwing**. The rear plinth feet are adjustable by drill holes in the carcase base. The height adjustability of the plinth feet makes for **easy and rapid adaptation to uneven floors**.

All these points guarantee rapid and economical assembly.

3. Ergonomics and innovation

- Working heights of 706 to 1100 mm** and **working depths of up to 1200 mm** make it possible to adapt the kitchen individually to the user or to the various working sequences.
- Instead of the standard plinth heights of 90, 120 or 150 mm, plinth heights of 90 up to 300 mm are available, if desired. This space should not go unused:
From 120 mm plinth height onwards, the "Magic Box" plinth drawer can be used and provides storage space from top to bottom.
- Not only the plinths, however, but also the two **base unit heights of 750 and 600 mm** make for ergonomically correct working heights.
- The **Matrix 150** offers extremely versatile planning for all room situations with its simple dimensional logic.
In addition to this **three dimensional grid**, there are further **innovations** that can have a decisive influence on the appearance of a kitchen: **Interior decor, worktops and panels 50 mm and 16 mm thick, planning depth 750 mm**, equipment characteristics such as **ChromLine, GlassLine or Arena S+** and still even more features to design a Nolte kitchen attractively.

4. Miscellaneous

- Solid wood fronts are sealed inside and out with a **scratch, impact and mark resistant lacquer coating**. This prevents the penetration of kitchen vapours and provides the fronts with a **high quality, brilliant surface finish**.
- All worktops are brand-name quality materials from well-known German manufacturers. The laminate coating is **resistant to all conventional domestic acids and solutions**, very hard wearing and therefore guarantees a long service life.
- Despite slight traces of use, which are inevitable on a worktop, the quality of our products remains the same.

Test report, Nolte Küchen

Test of suitability and quality of the products and materials

Customer: Nolte Küchen GmbH & Co. KG, Anni-Nolte-Straße 4, D-32584 Löhne

Subject: Verification of the total quality documentation for materials,
as well as verification of the product quality right up to the consumer.



Die Kompetenz
in Sachen Qualität

No.	Test	Requirement	Status	Comment
1.1	Pollutant reports by independent external institutes*	Currently	✓	Requirement met
1.2	Certification of surface quality by independent external institutes	Currently	✓	Requirement met
1.3	GS (Safety tested) safety certificate	Currently	✓	Requirement met
2.1	Material test reports by suppliers	Currently	✓	Requirement met
2.2	Emission test reports by suppliers	Currently	✓	Requirement met
2.3	Load tests by suppliers	Currently	✓	Requirement met
3.1	Verification of physical resistance	Currently	✓	Requirement met
3.2	Verification of chemical resistance	Currently	✓	Requirement met

(*) Explanation regarding item 1.1

No.	Test	Requirement	Comment
1.1	Formaldehyde emissions	0.05 ppm (RAL GZ 430) (Directive on prohibited chemicals: 0.1 ppm)	Requirement met
1.2	Emissions of volatile organic compounds (VOC)	CMT substances: After 24 h: K1 and M1 < 1 µg/m³, K2 and M2 ≤ 1 µg/m³, RF 1 and 2, RE 1 and 2 ≤ 10 µg/m³ After 28 days: all below the detection limit (< 1 µg/m³)	Requirement met
2.0	Odorous emissions	max. level 3: distinct, not unpleasant odour (mean value)	Requirement met

Summary:

The materials which we use are not only subject to statutory requirements, but are also considerably **lower** than required, thus meeting the requirements imposed for **healthy living**.

Our kitchen ranges are subject to permanent monitoring by neutral test institutes in addition to meeting with the DGM requirements.

- ▶ Our products are constantly **monitored** with regard to **safety**
- ▶ Components are **investigated** for **pollutant substances**
- ▶ Kitchen surfaces are tested as component parts **in accordance with DIN 68861**
- ▶ Our kitchen furniture is tested in **accordance with EN 14749**
- ▶ Our products are additionally **certified according to GOST**

Löhne, 15. September 2006

Monitoring



Supplier



Kitchens



GOST logo



Matrix 150 – simple. practical. good.



Matrix Line 150 – the success story continues.



Simply a more beautiful kitchen.

MATRIX *line150*[®]
by nolte küchen

MATRIX
150
NOLTE KÜCHEN

PERFEKT IN FORM UND FUNKTION



Advanced engineering from Germany.

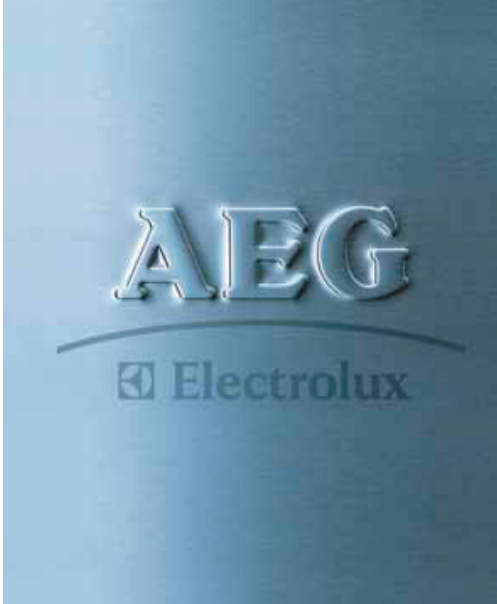

AEG. Founded in Germany over a century ago on a simple philosophy: everything it designs should be perfect in both form and function. Today, all AEG-Electrolux products remain true to these same Germanic principles. Premium form married to pioneering function. The AEG-Electrolux built-in range has been created with premium kitchens in mind – with design that enhances the overall look of the kitchen, together with the latest, high-performance technology to meet the most uncompromising standards.



Design and function.



Precision engineering.

AEG stands for Advanced Engineering from Germany, which represents unrivalled form, function and features. All our appliances offer outstanding performance, versatility and reliability with stylish aesthetics to enhance your kitchen design. AEG-Electrolux products are developed and manufactured with meticulous attention to detail, using the best of modern design and the very latest technology

Award-winning design.

AEG-Electrolux ovens have high performance design built-in, receiving several design awards including the prestigious IF Product Design Award 2008, the Red Dot Design Award 2008 and the Get Connected Award 2009. Look for the following accreditations throughout the brochure.



**red dot design award
winner 2008**



**product
design
award**

2008



Anti-fingerprint stainless steel.

This stylish finish from AEG-Electrolux takes the elegance and lustre of stainless steel one stage further, eliminating unsightly fingerprints and ensuring your kitchen looks effortlessly clean. All AEG-Electrolux ovens, microwaves and compact products feature this stylish finish.



The kitchen that sounds like a library.

Maintaining a peaceful home environment is a top priority for AEG-Electrolux. We believe a kitchen should not only be easy on the eye, it should also be easy on the ear.

AEG-Electrolux is so dedicated to producing quiet, high performance appliances that we have teamed up with the UK Noise Association (UKNA) to develop an accreditation showing which appliances operate extremely quietly. The UKNA have the following guidelines for 'quiet' appliances:

Dishwashers under	45dB(A)
Cooker hoods under	60dB(A)

If a peaceful kitchen is a priority for you, please look out for the logo on our quietest appliances.



Endorsed by the
UK Noise Association

Safety in mind.

Your safety and health is of paramount importance to us, that's why AEG-Electrolux appliances are always designed with safety in mind. Most of our ovens and hobs come with a child safety lock and an auto-safety switch off, whilst the safety thermocouples on gas hobs ensure that if the flame is inadvertently extinguished, the gas stops flowing immediately. Our engineers work hard to ensure that your kitchen is a safe, relaxing place.

Energy information.

AEG-Electrolux has always been committed to minimising electricity, water and detergent consumption. Most of our appliances achieve A or A+ energy and performance ratings, all of our double ovens are A/A rated, an industry first.

Our environmental policy minimises the ecological impact of every appliance at each stage of its life, from manufacture to disposal.



High performance in design.

The AEG-Electrolux range of ovens delivers the ultimate in style and performance, combining stylish, award winning design with truly advanced technology.



AEG-Electrolux's unique full size multifunction single oven with fully integrated steam functions or our new advanced multifunction single oven with digital auto-cooking achieve perfect results every time. The latest Avantgarde technology takes all the guesswork out of cooking and all AEG-Electrolux standard single ovens are 'A' energy rated for optimum performance.

Energy
A
Class

AEG-Electrolux's new range of built in and under-counter double ovens now feature UK market leading innovation – 'A' energy rating in both ovens, the latest technology and the most energy efficient range, for excellent economy. Electronic interactive LCD displays and digital cooking with temperature recommendation ensure complete control of the cooking process.

Perfect in form

AEG-Electrolux ovens have high performance design built in, receiving several design awards including the prestigious IF Product Design Award 2008 and the Red Dot Design Award 2008. The appearance of our ovens coordinates perfectly with all other kitchen appliances to enhance the appearance of every kitchen.

All AEG-Electrolux single and double ovens now feature anti-fingerprint stainless steel taking the elegance of steel to the next level, ensuring your oven always looks great in your kitchen.

Optimum cooking flexibility.

Anti-fingerprint stainless steel.

Our AEG-Electrolux models are designed with anti-fingerprint stainless steel, taking the style and elegance of stainless steel one stage further - ensuring your microwave always looks good.



True fan cooking and microwave.

Combination microwave - the fan cooking with microwave, for golden brown food cooked in about half the time.

Quick start control.

Enables you to cook for 30 seconds at full power at the touch of a single button, ideal for common tasks such as warming up drinks. Can be pressed up to 5 times continuously for convenience.

More/less time option.

For use with auto cook or defrost programmes. A simple button enables you to add more or less time to the cooking or defrosting time depending on the desired results, for example to cook medium or rare steak.

Glass turntables.

All microwaves have glass turntables to ensure even cooking, and an option to use without, if baking with a large dish.



Space solutions.

All our microwaves are small on the outside but spacious on the inside. Our range even includes a combi microwave that has a huge 38 litre capacity without taking up any more space in the kitchen than a standard microwave.

Installation.

All AEG-Electrolux microwaves are fully built-in so no building-in kits are required, giving easy installation and a perfect fit.

The MCC3880EM, MCD3880EM and SOLO microwaves come with a choice of installation positions and can be built in under counter as well as in-column, offering the flexibility to fit into your kitchen design. All other models should be built in-column and 60cm models can be built over an oven or refrigerator. The 17 litre models are available in a choice of 50cm or 60cm wide versions for installation in a ventilated aperture 30cm deep.

Automatic programmes.

Cleverly devised programmes allow defrosting, cooking and combination cooking to be accomplished automatically at the touch of a button. Simply enter the weight of the food, and the microwave does the rest.



A range of cooking programmes.

Combine microwave and traditional cooking with the DUO range (with integral grill) and COMBI range (with fan and grill cooking). Traditional cooking methods can be used independently or with the microwave function for maximum time saving.

Microwave power levels.

A choice of 1000W, 900W or 800W are available within the AEG-Electrolux range. The levels are adjustable, dependant on the type of cooking.

Combi microwave.

Combine the microwave with the browning and crisping effect of grilling or fan cooking, giving you speed and fantastic results.



Quartz grill.

Fast heat up time, with a smooth surface for easy cleaning.



Stunning visual impact.

AEG-Electrolux offers a vast range of stylish hobs with the very latest technology for high performance cooking with stunning visual impact, including our design-award winning Maxi-sense models. Ceramic and Induction hobs add form and function to any kitchen design, with sleek bevelled edges and smooth touch controls.

Perfect in form

AEG-Electrolux ceramic and Induction hobs are designed to be the focal point of your kitchen, combining the very latest technology, innovative and practical features with elegant designs.

AEG-Electrolux electric hobs offer a range of style options including polygon and rectangular shapes, 103cm widths and bevelled glass edges will enhance the appearance of any kitchen.

Perfect control

'Direktouch'.

AEG-Electrolux's electronic 'Direktouch' controls use the very latest digital technology to ensure precise heat selection. The electronic touch controls enable you to directly access the desired cooking level or simply slide your finger along the scale until you reach the required heat setting.

Automax.

AEG-Electrolux's highly intelligent Automax function provides fantastic automatic zone control, so you do not have to constantly monitor the pans on the hob. After selecting a power level and cooking time, this function brings the zone up to the boil and will then reduce it to the pre-selected power level for the remainder of the cooking time.

Stop+Go.

At the touch of a button, all zones are reduced to a keep warm level, and then when the button is touched again it returns the zones exactly to the previous level. This feature is perfect when you need to leave the hob for an unexpected call.

Power booster.

Most AEG-Electrolux hobs also feature the Power booster function providing an intense rapid heat up, saving time.

Timer.

A timer of up to 99 minutes can be programmed for each individual cooking zone allowing you precise control. Once the cooking time is complete, the hob will automatically switch itself off and an acoustic signal will sound.

Perfect in function

All AEG-Electrolux ceramic hobs feature Hilight zones. This latest heat technology incorporates a fine ribbon element under the glass to provide full heat in less than five seconds. Extremely responsive, it saves both time and energy.

Multi-purpose zone.

An elongated oval zone that can be used as a single zone with just the circular section activated or extended to accommodate casseroles and fish kettles.

Triple zone.

This ceramic cooking area comprises three different sized zones, which can be activated to complement the size of saucepan being used.

Dual zone.

Convenient and highly efficient, this two zone cooking area can be used for larger pans or activate the middle section for smaller cookware.

Perfect safety

For complete peace of mind, many of AEG-Electrolux's hobs can be locked to prevent children accidentally turning it on. In addition, the control lock prevents any alteration or activation of the hob's settings. Simply lock the controls once the cooking functions have been selected. This feature can also lock the hob in the off position for added peace of mind.

Many AEG-Electrolux electric hobs automatically switch off if left on for excessive time periods.

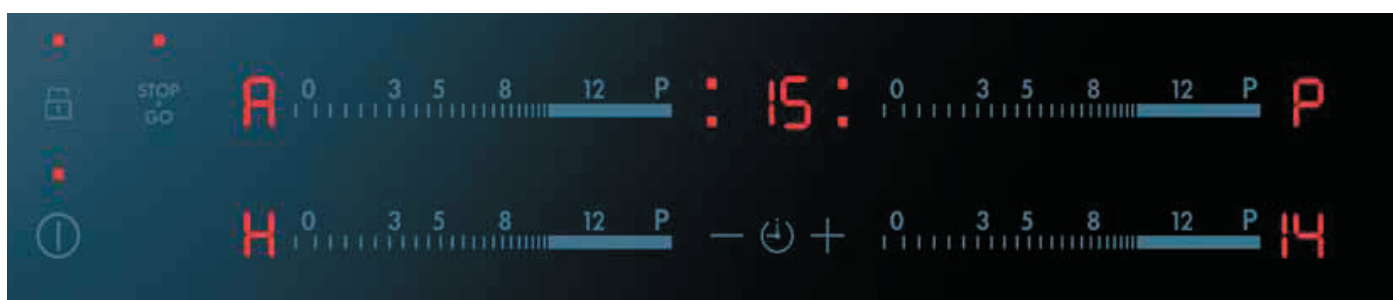

Award winning design.



Induction – the definitive electric hob cooking technology is faster and more responsive than gas.

Perfect in form and function

AEG-Electrolux Induction hobs provide the ultimate in style, sleek bevelled edges and smooth touch controls, with the latest advanced features to provide real cooking flexibility and perfect results.

How Induction works

With a conventional electric hob, the entire cooking zone heats up, this in turn, heats the base of the pan. Induction hobs use an electromagnet underneath the ceramic glass, creating a magnet field when a pan is placed on the cooking surface. Induction hobs automatically sense the size of the pan, only heating the base of the pan and its contents, ensuring the surrounding area always remains safe to touch.

Precision and control is the best with Induction hobs, dishes are cooked more quickly because the cooking area reaches the desired area temperature immediately. Temperatures can be adjusted instantly so precision and control is second to none - you can prevent a pan from boiling over without taking it off the hob. Pans will reach high heat quickly, so Induction is perfect for searing meat or fish yet is gentle enough to melt chocolate directly in the pan.

Pot recognition indicators maximise safety and controllability. The hob senses the size of the pan and only heats the exact area covered by the pan. Even if the hob is accidentally switched on, it will not heat up unless a pot or pan is placed on. If the incorrect cookware is used or the pan is removed from the surface, it breaks the magnetic field making Induction cooking extremely energy efficient.

AEG-Electrolux Induction hobs are extremely easy to keep clean. The smooth ceramic surface can be wiped clean easily and quickly, and spillages cannot burn or bake on because the area surrounding the pans stays cool.

Maxi-sense.

AEG-Electrolux offers the ultimate Induction cooking technology with the design-award winning Maxi-sense range of hobs. The Maxi-sense range provides the largest usable Induction area on the market using 'flexible sections' to create an all over cooking surface. Pans can be placed anywhere on the hob as long as the section marker is covered, eliminating the restriction of traditional specific zones. It does not matter how many pans you have or what size they are, whether it is a fish kettle, a small milk pan, or tagine you can be assured of excellent results with Maxi-sense.

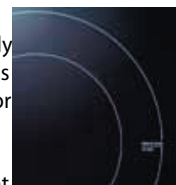

Precise control for peace of mind.

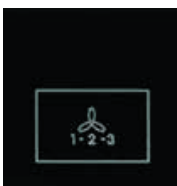

The AEG-Electrolux design-award winning range of hoods will complement any kitchen. From unique designer hoods to stylish chimney and island hoods, each is individually designed to co-ordinate perfectly with your AEG-Electrolux oven and hob.



AEG-Electrolux's powerful hoods make a real difference to your whole kitchen environment, ensuring that it is a fresher, more peaceful place to cook or relax. Whisper quiet operation means your kitchen is cleared of cooking odours efficiently and quietly. The UK Noise Association endorses many of the AEG-Electrolux hoods. If a peaceful kitchen is a priority for you, please look out for the logo.

Designer hood in stainless steel.



HD8795M



HD8760M

HD8795M - 90cm wide

HD8760M - 60cm wide

Designer hood in stainless steel.

- ⊗ Electronic rotary control with colour display for speed, filter and light settings
- ⊗ Variable 4 speed control including 1 intensive setting for precise control and optimum efficiency
- ⊗ Electronic dimmer control for softer lighting

PERFORMANCE
540m ³ /h extraction rate
61dB(A) noise level
REASSURANCE
Charcoal filter included
Washable aluminium grease filters
Electronic saturation indicators
Extraction and recirculation
DESIGN
3 halogen lamps
For wall mounting between furniture or as a stand alone unit
Chimney section available as an optional extra (K8004m)



Precise control for peace of mind.



Precise control.

A host of advanced features offer you total control over your high-performance AEG-Electrolux cooling appliance. All fridge freezers feature an adjustable thermostat for easy adjustment of the internal temperature of the fridge freezer. The Coolmatic feature on fridges offers you fast chilling of fresh foods, whilst the Frostmatic feature quickly freezes food just placed in the freezer, ensuring all food is stored in optimum condition. Simple controls make operation easy and both Coolmatic and Frostmatic automatically switch off after a set period and return to normal temperature.



Maintaining perfect conditions.

The holiday mode sets the temperature of the fridge cabinet to 14°C without affecting the freezer. This is very useful particularly on occasions where the fridge will not be used for an extended period of time (e.g. holidays). The temperature set by the holiday mode allows the preservation of food such as butter and eggs and it prevents the creation of unpleasant odours whilst the door remains closed for a long period of time. Once back from holidays it will be easy for the fridge to recover to its normal temperature.

Advanced electronic interface.

Advanced electronic temperature controls are simple to use and ensure precise temperature control. The controls are child proof and the LCD /LED display provides reassurance that the optimum temperature is being maintained, providing the best conditions for your food.

High Temperature Indicator signals if the temperature rises (such as during a power cut). Door Indicator (visual and/or audible) signals if the door is open. Service Indicator signal if there is a fault requiring technical assistance.



Store food in perfect conditions.



Keep food fresher for longer.

Longfresh Chill Zones allow food to be kept fresher for longer at a low temperature of around 0-3°C. The natural humidity level of the food can be manually controlled with the humidity control device. Lower humidity is ideal for storing meat, fish and dairy products, whilst higher humidity is perfect for fruit and vegetables. So your fresh food can be safely kept for longer in optimum condition, retaining vitamins and nutrient content, flavour and appearance. This feature is perfect for those with a busy lifestyle who would rather do one big shop than lots of smaller ones.

Covered dairy compartment.

The covered dairy compartment for cheese and butter ensures dairy to be kept at the ideal temperature. There is also a range of full and half depth shelves which offer increased storage flexibility.

K-glass.

The K-glass door protects the wine from the harmful effects of the ultra-violet rays and the smooth gliding shelves mean that you can select any bottle without disturbing the rest.

Wine storage.

Our new wine store is designed to keep wine in perfect condition. The variable temperature on the shelves is perfect for storing white wine, red wine and Champagne at the ideal temperature. The humidity levels are kept high to prevent corks shrinking.



Coolmatic.

By simply choosing the coolmatic setting the temperature is set to +2°C allowing you to quickly chill new shopping to preserve the flavour, colour and nutritional value of the foods as well as protecting food that is already being stored. This function automatically returns to the pre-selected temperature.

Electronic controls.

The AEG-Electrolux electronic controls advise if the temperature is correct. Audible alarms sound if the temperature increases or the door is left open.



Extra strong glass shelves.

Extra strong glass shelves retain the cold, are easy to clean and can prevent spillages contaminating the other foods.





No more defrosting.

AEG-Electrolux frost-free freezers completely remove the need to defrost your freezer, giving you total convenience and saving the valuable time cleaning. Frost-free freezers also offer efficient and effective freezing with quicker, more even chilling for better food preservation. Food never sticks together or gets frosted over so you can easily find what you are looking for.

In addition, we have the first 50:50 total frost-free fridge freezer. A unique air circulation system ensures that both the fridge and the freezer remain frost and condensation free. All other fridges in the range also feature "auto-defrost".



Frostmatic.

The Frostmatic feature is ideal when putting fresh food in the freezer, electronic controls quickly freeze the food to the preset temperature, preserving the flavour, nutritional value and colour of food, in addition to protecting already frozen food. This function automatically returns to the pre-selected temperature.



Efficient freezing.

The turbo freezing function is ideal when putting fresh food in the freezer. The push button control freezes the food as fast as possible to preserve flavour, nutritional value and colour of food.



Premium freezer compartments.

A range of versatile storage is provided in AEG-Electrolux cooling appliances to ensure the very best food preservation.

4-star freezer compartments.

All of our models have 4-star freezer compartments enabling you to freeze fresh food. Store frozen foods for up to one year with excellent visibility of frozen foods.



Maxi box drawer.

The maxi box is ideal for freezing those larger items from the Christmas Turkey to birthday cakes.

Stylish design with a high quality build .

AEG-Electrolux dishwashers combine stylish design with the very latest technology to achieve sparkling results using the least amount of time, energy and water.



Stylish design.

AEG-Electrolux dishwashers combine stylish design with robust, high-quality build to fit perfectly into any kitchen size or layout. Standard sized dishwashers can be either fully-integrated behind furniture or semi-integrated with the stylish display on show. For kitchens where space is at a premium, there is a slimline dishwasher or a compact dishwasher, which perfectly co-ordinate with AEG-Electrolux compact products.



Endorsed by the
UK Noise Association

Whisper-quiet operation.

AEG-Electrolux has the world's quietest dishwasher range, which is economical by design, combining energy efficient operation with unbeatable performance.

Energy efficient.

AEG-Electrolux is committed to minimising the amount of electricity, water and detergent used by household appliances. Three elements are measured: energy rating (running costs) wash performance (cleanest results) and drying performance (quickest drying results).

Many models now consume only 12 litres of water and most of our dishwashers have eco-friendly 'AAA' class ratings, achieving maximum energy efficiency.



Fully-integrated dishwasher.

The dishwasher is hidden behind a full height furniture door and operated by controls on the top edge of the dishwasher door.

Semi-integrated dishwasher.

The dishwasher has a visible control panel, which matches in height to the control panel of an oven and drawer line furniture. A short furniture door is fixed below the control panel.



Compact dishwasher.

Ideal for smaller households or apartments, where kitchen space is at a premium. Mix and match with the AEG-Electrolux range of compact products.

Slim-line dishwasher.

A 45cm fully integrated dishwasher for smaller spaces.

Extra high.

Some dishwashers within the range provide extra space inside the cavity for more flexible loading of larger pots and pans.

Top performance on all levels.

LCD display.

Smart LCD display provides all the information needed - such as the programme selected and the time remaining in a clear and precise way.

Auto programme.

Now there is no need to decide which programme is the most suitable for the dishes. With auto programme, the dishwasher decides. Using advanced sensors, the dishwasher will modify the time, temperature, water and energy consumption based on the soiling level to produce optimum results in the most efficient way. The temperature ranges from 45°C to 70°C, making it ideal for the most delicate of glassware to the dirtiest of dishes.

Night cycle.

In order not to disturb sleep, the night cycle runs at just 39dB, making this the quietest dishwasher on the market.

Quick 55.

This programme runs at 55°C and can wash a full 12 place setting capacity in just 55 minutes.

Eat-Load-Go.

This specially designed programme is perfect to meet the demands of a busy schedule and is ideal for entertaining. It saves time by enabling the starter dishes and crockery to be washed in time for dessert. The only quick wash that delivers an A rated wash in just 30 minutes, it cleans a four place setting capacity at 60°C.

Intensive 70°C.

An advanced wash, where the final hot rinse is extended by 11 minutes to produce a more hygienic and ultra clean finish.

Glass care 45°C.

Powerful enough to thoroughly clean glasses yet gentle enough to care for them. This feature includes adjustable glass supports for extra stability.

Rinse hold.

A cold rinse removes food deposits and holds the wash until there is a full load.

Auto half load.

Using the latest dishwashing technology, auto half load allows the dishwasher to determine whether there is a full or half load and will moderate the water and energy consumption accordingly.

Multi-tab.

All models come with a multi-tab button, which optimises the cleaning results of all-in-one detergents. It modifies the time and temperature of each phase of the programme to ensure that all elements of the detergent are released at the correct part of the cycle for sparkling results every time.

Active drying.

For an improved drying result, the active drying system aids the natural circulation of moist air through a condensing unit.



Enhanced features and flexibility.



Third spray arm.

For an extra clean wash, some of our dishwashers have a third spray arm, thus adding another dimension.

Flexible upper basket.

For convenient loading, a height adjustable upper basket allows large dishes and plates to be stacked with ease.



Interior light.

To assist with loading and unloading, the interior light illuminates the inside cavity. Fitted with LEDs, it will never need to be changed and uses minimal energy.

Cutlery tray.

The cutlery tray in the top basket is ideal for larger items such as knives, spatulas and ladles.



Fold out cutlery basket.

Enables clean cutlery to be removed more hygienically and easily.

Spot light.

Our dishwashers are so quiet that you won't know that they are on. To show when the programme is running, all of our fully integrated models feature a red light beam, which projects onto the floor. On some models this turns green when the programme has finished.

Delay start.

This highly practical function gives more control over when the dishwasher is used, as the programme can be delayed to start at a chosen time.



The perfect design solution.



Performance.

Stain action.

AEG-Electrolux washing machines have stain option which is a dedicated stain programme, allowing the use of stain removal agents along with normal detergent for the most effective results. By integrating a fourth compartment, the stain remover is only dispensed once the wash reaches 40°C, making stain treatment more effective.



Fuzzy Logic.

Calculates the precise amount of water required for the main wash and rinse, resulting in the best wash and rinse performance with the lowest water, detergent and energy consumption.

Superior insulation.

Ultra quiet models are equipped with noise insulation panels, which absorb high frequency noise, useful during the spin cycle when noise is at a maximum. This feature makes AEG-Electrolux washing machines noticeably quieter.

Silent system.

AEG-Electrolux is dedicated to producing a high performance laundry range with whisper-quiet operation. Using the very latest in advanced technology, washing machines deliver optimum results with extremely low noise levels – perfect for open plan living and late night laundry.

Design.

LCD display.

For essential user feedback, a stylish illuminated LCD display provides instant information to the user.

Energy efficiency.

All AEG-Electrolux washing machines are A+ or A rated (A+ for energy, A for wash) to deliver the best in class results every time, optimising the use of energy and water.

Large portholes.

AEG-Electrolux laundry appliances are also easy to load and unload with large portholes and wide door openings.



The optimum wash performance.

Control.

Time save.

For total control over the duration of the wash, the time save option offers three settings – normal, quick and very quick - reducing the time of the programme whilst still providing an A rated wash. Reduce the wash time by up to 25% for a 6kg (30shirts) load at 60°C by pressing the button once and up to 60% by pressing it twice.

Delay start.

Ensures laundry is ready exactly when required, reducing creasing and musty odours.

Aqua control.

An internal system monitors the water level to detect any possible leaks in the inlet pipe or wash drum. This completely eliminates any possibility of flooding.



Sensor drying.

All our AEG-Electrolux washer dryer laundry appliances give you exceptional drying results and total control. Simply choose the required level of dryness from machine iron for slightly damp clothes to extra dry for ready-to-wear clothes. The machine will sense when the clothes are dried to the specified levels and automatically stop the machine. With the sensor dryer, you do not need to keep checking if your clothes are dried and you also save on energy costs and avoid over drying as well.

Variomatic spins.

Alternating progressively faster spinning with frequent tumbling stages provides the best possible wash results with minimal creasing.

Care.

Innovative programmes.

For optimum wash results, AEG-Electrolux washing machines offer an outstanding range of programmes. The wool plus programme gently rocks woollens at 40°C for an effective yet sensitive clean. The delicate programme is designed for mixed fabrics found in delicate clothes.

Eco wash system.

The eco wash system ensures maximum wash efficiency as it prevents any loss of detergent. The eco valve ensures that all the detergent stays in the wash drum by closing the drain area completely.

Easy iron.

The easy iron option reduces the need for ironing by up to 50% through actively reducing creases in fabric caused throughout the wash and spin cycle.



Refresh programme.

Refresh is a quick wash programme for lightly soiled or worn once clothes which is great at removing any odours and refreshing clothes. In the refresh programme up to 3kg (15 shirts) of clothes are washed at 30°C.

Sensitive option (washers only)

Designed specifically for those who are extra sensitive to dirt, dust and pollen, this programme is suitable for cotton and synthetics. The fabric is gently moved around while an extra rinse option ensures that any particles are effectively rinsed away.



IEC SYSTEM FOR MUTUAL RECOGNITION OF TEST
CERTIFICATES FOR ELECTRICAL EQUIPMENT
(IECEE) CB SCHEME

SYSTEME CEI D'ACCEPTATION MUTUELLE DE
CERTIFICATS D'ESSAIS DES EQUIPEMENTS
ELECTRIQUES (IECEE) METHODE CC

CB TEST CERTIFICATE

Product
Produit

Oven for building-in

Name and address of the applicant
Nom et adresse du demandeur

AEG Hausgeräte GmbH
Fürther Straße 246, 90429 Nürnberg
GERMANY

Name and address of the manufacturer
Nom et adresse du fabricant

AEG Hausgeräte GmbH Electrolux Home Products
Bodelschwinghstrasse 1, 91541 Rothenburg o. d. T.
GERMANY

Name and address of the factory
Nom et adresse de l'usine

AEG Hausgeräte GmbH Electrolux Home Products
Bodelschwinghstrasse 1, 91541 Rothenburg o. d. T.
GERMANY

Note: When more than one factory, please report on page 2
Note: Lorsque il y a plus d'une usine, veuillez utiliser la 2^{ème} page

Ratings and principal characteristics
 Valeurs nominales et caractéristiques principales

☒ Additional information on page 2
Rated voltage: a, b, c) AC 230 V or AC 220 - 240 V
d) 230 - 240 V
Rated power input: 3,0 kW resp. 3,5 kW

Trademark (if any)
Marque de fabrique (si elle existe)

AEG-Electrolux

Model / Type Ref.
Ref. De type

91 ... *) ... *)

Additional information (if necessary may also be
reported on page 2)
Les informations complémentaires (si nécessaire,
peuvent être indiqués sur la 2^{ème} page

*) additional characteristic for equipment and design
according to appendix

☐ Additional information on page 2

PUBLICATION

EDITION

A sample of the product was tested and found
to be in conformity with
Un échantillon de ce produit a été essayé et a été
considéré conforme à la

IEC 60335-1(ed.4);am1;am2
IEC 60335-2-6(ed.5);am1, IEC 62233(ed.1)

As shown in the Test Report Ref. No. which forms part
of this Certificate
Comme indiqué dans le Rapport d'essais numéro de
référence qui constitue partie de ce Certificat

11162-2271-0396/129432

This CB Test Certificate is issued by the National Certification Body
Ce Certificat d'essai CC est établi par l'Organisme National de Certification

VDE Prüf- und Zertifizierungsinstitut GmbH
VDE Testing and Certification Institute
Zertifizierungsstelle / Certification

Date: 2010-03-04

Signature:

R. Köhn

IEC SYSTEM FOR MUTUAL RECOGNITION OF TEST
CERTIFICATES FOR ELECTRICAL EQUIPMENT
(IECEE) CB SCHEME

SYSTEME CEI D'ACCEPTATION MUTUELLE DE
CERTIFICATS D'ESSAIS DES EQUIPEMENTS
ELECTRIQUES (IECEE) METHODE CC

CB TEST CERTIFICATE

Product
Produit

Glass ceramic hob for building-in with control panel

Name and address of the applicant
Nom et adresse du demandeur

AEG Hausgeräte GmbH
Muggenhofer Straße 135, 90429 Nürnberg
GERMANY

Name and address of the manufacturer
Nom et adresse du fabricant

AEG Hausgeräte GmbH Electrolux Home Products
Bodelschwinghstrasse 1, 91541 Rothenburg o. d. T.
GERMANY

Name and address of the factory
Nom et adresse de l'usine

AEG Hausgeräte GmbH Electrolux Home Products
Bodelschwinghstrasse 1, 91541 Rothenburg o. d. T.
GERMANY

Note: When more than one factory, please report on page 2
Note: Lorsque il y a plus d'une usine, veuillez utiliser la 2^{ème} page

Ratings and principal characteristics
 Valeurs nominales et caractéristiques principales

Rated voltage: AC 220 - 240 V, AC 230 V, 2N AC 400 V
resp. AC 400 V
Rated power input: max. 7,9 kW (see test report)

Trademark (if any)
Marque de fabrique (si elle existe)

AEG-Electrolux

Model / Type Ref.
Ref. De type

55 *)

Additional information (if necessary may also be
reported on page 2)
Les informations complémentaires (si nécessaire,
peuvent être indiquées sur la 2^{ème} page

*) type reference see test report

☐ Additional information on page 2

PUBLICATION

EDITION

A sample of the product was tested and found
to be in conformity with
Un échantillon de ce produit a été essayé et a été
considéré conforme à la

IEC 60335-1(ed.4):am1;am2
IEC 60335-2-6(ed.5):am1

As shown in the Test Report Ref. No. which forms part
of this Certificate
Comme indiqué dans le Rapport d'essais numéro de
référence qui constitue partie de ce Certificat

11162-2271-0426/105201

This CB Test Certificate is issued by the National Certification Body
Ce Certificat d'essai CC est établi par l'Organisme National de Certification

VDE VERBAND DER ELEKTROTECHNIK
ELEKTRONIK INFORMATIONSTECHNIK e.V.
VDE Prüf- und Zertifizierungsinstitut
VDE Testing and Certification Institute
Zertifizierungsstelle / Certification

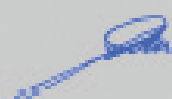

Date: 2008-11-28

Signature: R. Elm



PERFEKT IN FORM UND FUNKTION

AEG

Electrolux



يونيفرسال
UNIVERSAL

UNIVERSAL TRADING COMPANY

P.O. Box 4399
Abu Dhabi - United Arab Emirates
Tel: +9712 6335331
Fax: +9712 6211957
Website: www.universal-uae.ae

UNIVERSAL ELECTRICAL EQUIPMENT EST.

P.O. Box 6809
Dubai - United Arab Emirates
Tel: +9714 3248112
Fax: +9714 3248113

UNIVERSAL TRADING COMPANY

P.O. Box 15320
Al Ain - United Arab Emirates
Tel: +9713 7216660
Fax: +9713 7214646